

## 6 Angle Ways, Peartree, Stevenage, Herts, SG2 9AW

Geoffrey Matthew Property Management are delighted to offer for let this STUDIO APARTMENT with Modern Fitted Kitchen and Bathroom, OPENPLAN LOUNGE AND BEDROOM AREA, Benefiting from Communal Gardens, located in the Peartree area within Walking Distance to Fairlands Valley Park. AVAILABLE LATE APRIL.

A holding deposit equivalent to one weeks rent is payable to apply for this property

Viewing is recommended.

- Spacious Studio Flat
- Close to Town Centre
- Modern Fitted Kitchen
- Bathroom
- Communal Gardens
- Viewing recommended
- Available late April

£900 Per Calendar Month

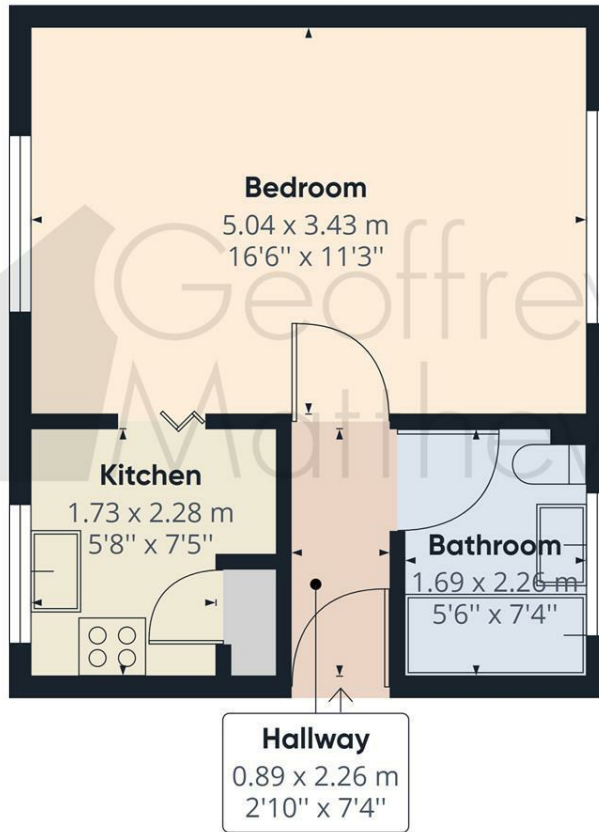

Approximate total area<sup>(1)</sup>  
306.72 ft<sup>2</sup>  
28.50 m<sup>2</sup>

(1) Excluding balconies and terraces

While every attempt has been made to ensure accuracy, all measurements are approximate, not to scale. This floor plan is for illustrative purposes only.

GIRAFFE360

